

Operation methods

Most operations can be done by touching the screen directly. You can also operate with a gloved hand or by using a stylus.

Tips The touch screen on the EyeSpecial C-II is different from a touch screen on a smart phone. Gently touch the screen with your finger nail or the tip of your finger.

* You can also operate this camera with the Function Keys (F1-F4) located on the left side of the LCD screen. For more details, refer to page 4 in the User's Manual.

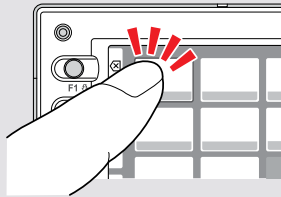

Turn the camera on

Rotate the Power switch to turn the camera on.

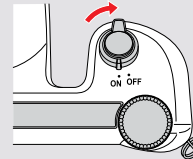

When "Press any key or touch the LCD screen" appears on the screen, you can start taking pictures.

* When you first turn the camera on, you may need to set the language, date, time and unit. For more details, refer to page 10 in the User's Manual.

Take pictures

Follow procedures 1 – 5 to take pictures.

1 Input patient information (optional)

* For more details, refer to page 14 in the User's Manual.

2 Select Shooting Mode

Press **Mode** to display all the modes preinstalled. Select the optimal mode for each purpose.



* For more details on each mode, refer to the back of this Quick Reference.

3 Select magnification ratio

Adjust the magnification ratio by rotating the Dial key. (Cannot change the magnification ratio by touching the screen)

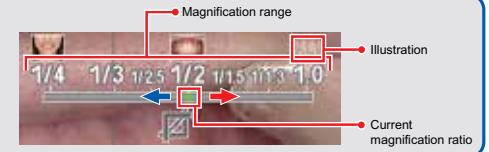
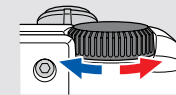

4 Set focus distance

Based on the optimal focus distance displayed on the upper area of the screen, adjust the distance between the camera and the subject. Change the camera position until the subject appears on the screen clearly.

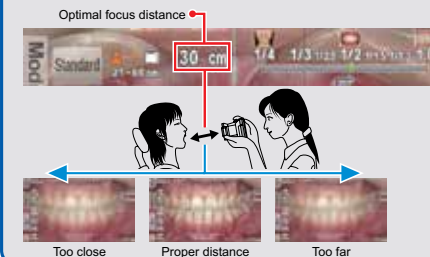

Tips When taking pictures in Face Mode

When the "▲UP" icon appears on the screen, hold the camera as indicated by the ▲ icon.



5 Focus and take picture

Half-press the Shutter button to focus. When it's focused properly, green focus indicator appears on the right bottom of the screen. Then, press the Shutter button completely down to capture the photo.

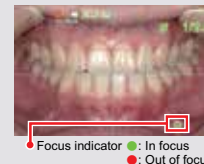
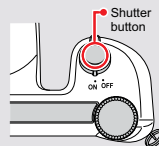

Tips SPOT Auto-focus

You can focus the area outside of the Auto-focus area by touching the area you wish to focus directly on the screen (SPOT AF Mode). For returning to standard AF mode, hold down the spot-focused area for a few seconds.

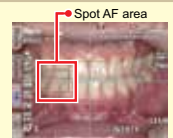

* Should you inadvertently press any keys while shooting and another menu appears, half-press the Shutter button to return to Shooting Mode.

* You can attach patient ID to the pictures or you can register your custom settings in the camera. For more details, please refer to page 14 in the User's Manual.

Viewing your image

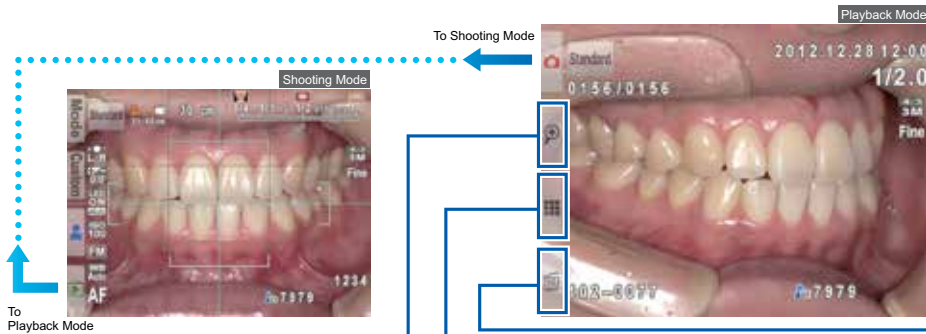

Touch **OK** key in Shooting Mode to change to Playback Mode. The last picture you took is displayed.

Rotate the Dial key to scroll through pictures.

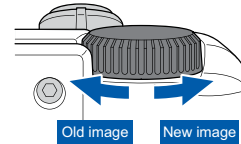

Magnifying image

Thumbnail images

To display a single view, select one image by touching it on the screen.

Erasing images

If you wish to erase the image, press "OK" to proceed. Or press "CANCEL" to cancel erasing.

Edit functions

Press MENU Key while displaying an image you wish to edit.

For more details, please refer to page 29 in the User's Manual.

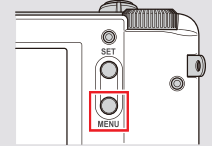

1. Draw on images

Draw lines on the images by touching the screen.



2. Rotate images

The images can be rotated 90°.



3. Protect images

Protect the images to avoid accidental deletion or unintended editing.

Install batteries and insert SD Memory Card

Install batteries

Compatible batteries

AA batteries×4

(Rechargeable Nickel-hydride batteries or alkaline batteries)

How to open and close the Battery cover

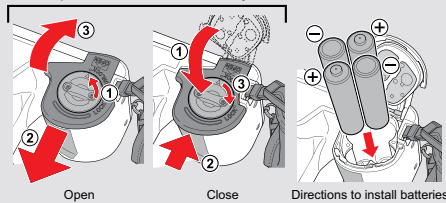

Insert SD Memory Card

Compatible SD Memory Card



* Logos of SD Memory Card, SDHC Memory Card, and SDXC Memory Card are trademarks of SD-3C, LLC.

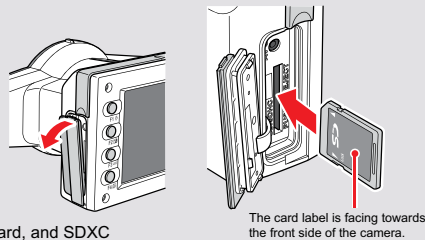

Shooting Modes

		Standard Mode For standard intraoral photography			Low-glare Mode For photographing details of anterior teeth, working models and indirect restorations
		Surgery Mode For intraoral photography from a distance			Whitening Mode For shade comparison between before and after whitening
		Mirror Mode For intraoral photography using a mirror The image taken can be reversed.			Tele-macro Mode For photographing anterior teeth, indirect restorations and working models in higher magnification * Attach provided Close-up lens when taking pictures in this mode.
		Face Mode For shooting facial views or half-body portrait			Isolate shade Mode You can isolate the shade for optimal shade matching.

EyeSpecial **C-II** Quick reference

Manufacturer
SHOFU INC. Kyoto 605-0983, Japan
SHOFU DENTAL CORPORATION San Marcos, CA, USA SHOFU DENTAL ASIA-PACIFIC Singapore
SHOFU DENTAL GmbH Ratingen, Germany SHOFU DENTAL TRADING (SHANGHAI) China